

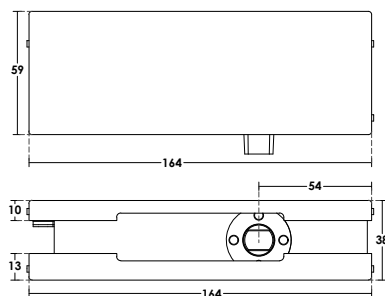

**ML03**

**FH30 Top**



**FH30 Bottom**

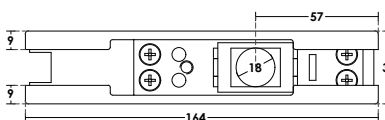
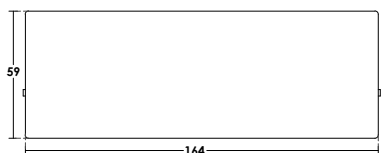

**PCA-FH30**

**Facade Top & Bottom Fitting SET**

8-12mm | Glass Thickness  
 60 kg | Max. Weight  
 Stainless Steel 304 | Material  
 Satin | Finish

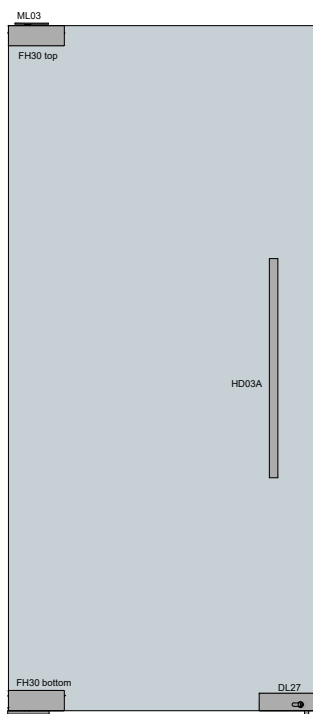

**1 x FH30 SET top & bottom**



**1 x ML03**



**1 x DL27**



**1 x HD03A (Optional)**

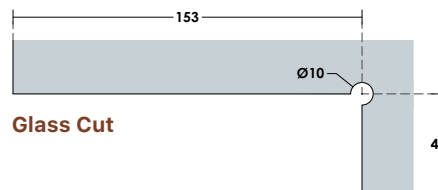
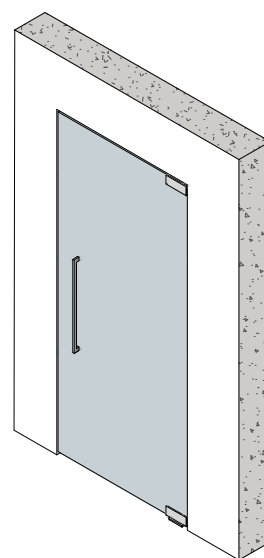

**Glass Cut**

- DESCRIPTION:**
- Material SS304 Satin
  - Fit for 8-12mm tempered glass
  - Max width 1000mm, Max weight capacity 60 kg
  - 4° alignment adjustment
  - Max open at 150 degree, hold open at 90 degree
  - 1,6 cm adjustment
  - Durability 500.000 cycles testing

**NEW**

**HYDRAULIC GLASS DOOR HINGE**



FAÇADES

**PCA-FH31**

**Hydraulic Hinge**

8-14mm | Glass Thickness  
 100 kg | Max. Door Weight  
 95° double action | Max. Opening Angle  
 240cm | Max. Door Height  
 100cm | Max. Door Width  
 Stainless Steel | Material  
 Satin | Finish

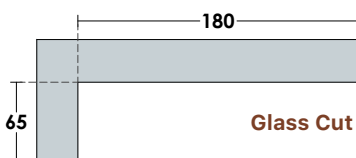
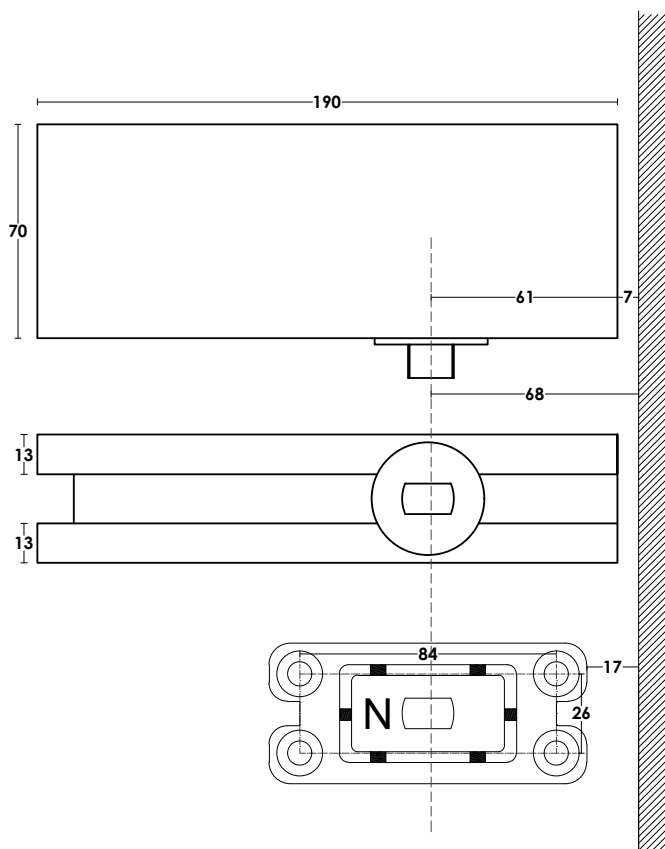

-Compatible with upper patch **FH02** or **FH27**

**DESCRIPTION:**

- Material SS304 Satin
- Fit for 8-14mm tempered glass
- Max width 1000mm, Max weight capacity 100 kg
- Two speed adjustment
- Max open at 150 degree, hold open at 90 degree
- Durability 500.000 cycles testing